

## CROMWELL Qualfast. M16x20x60 SKT SHOULDER SCREW H8 (GR-12.9)

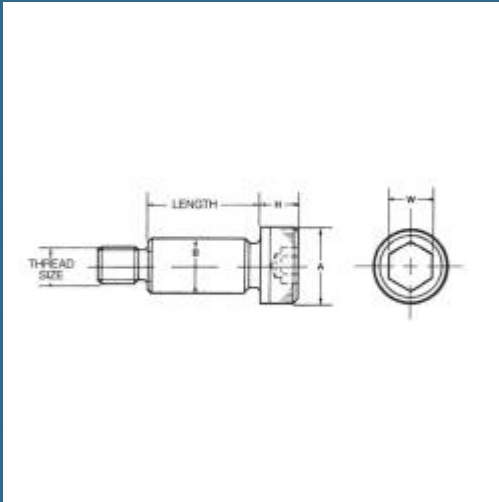

Cod produs:

**QFT6101660Z**

preturile contin TVA 19%

### Caracteristici

**Dimensiuni ambalaj:**

Lungime mm: 10

Latime mm: 3

Inaltime mm: 3

Greutate g: 240

**Despre produs**

High Grade Alloy Steel. Suitable for replacing costly components such as shafts, pivots, guides, pins, linkages and trunion mountings. Also commonly used in the die mould industry. Maximum operating temperature (Un-plated): 300°C. Body Diameter Tolerance h8